

PLAT # 488

78.00
2000
01/10/10 PH 3:55
KIRKHAM MICHAEL CONSULTING ENGINEERS
1110 WEST DODGE ROAD
DANNA, NEBRASKA 68124
(402) 393-5630

DIERS ADDITION

TO THE CITY OF FREMONT, DODGE COUNTY, NEBRASKA
A PLATTING BEING PART OF THE SW 1/4, NW 1/4 AND THE NE 1/4 OF
SECTION 18, TOWNSHIP 17 NORTH, RANGE 9 EAST OF THE 6TH P.M.

LEGAL DESCRIPTION

I, ROBERT M. TICHY, A REGISTERED LAND SURVEYOR IN THE STATE OF NEBRASKA, DO HEREBY CERTIFY THAT A SURVEY OF THE OUTER BOUNDARIES OF THIS PLAT OF DIERS ADDITION HAS BEEN MADE BY ME OR UNDER MY DIRECT SUPERVISION, AND THAT I SHALL INSTALL PERMANENT IRON PINS AT THE CORNERS OF ALL LOTS AS SHOWN ON THIS PLAT OF DIERS ADDITION. THE LIMITS AND BOUNDARIES OF SAID PLAT ARE AS FOLLOWS:

A TRACT OF LAND BEING PART OF THE SW 1/4, NW 1/4 AND THE NE 1/4 OF SECTION 18, TOWNSHIP 17 NORTH, RANGE 9 EAST OF THE 6TH P.M., DODGE COUNTY, NEBRASKA, MORE PARTICULARLY DESCRIBED AS FOLLOWS:

BEGINNING AT THE WEST 1/4 CORNER OF SAID SECTION 18, THENCE NORTH 00°00'00" (ASSUMED BEARING), ALONG THE WEST LINE OF THE NW 1/4 OF SAID SECTION 18, 233.00 FEET; THENCE NORTH 89°52'00" ALONG A LINE BEING THE WEST LINE OF AND PARALLEL TO THE SOUTH LINE OF THE NW 1/4 OF SAID SECTION 18, 2190.31 FEET; THENCE NORTH 00°00'00", 688.92 FEET; THENCE NORTH 00°00'00", 384.42 FEET TO THE BEGINNING OF A CURVE TO THE RIGHT, THENCE ALONG SAID CURVE TO THE RIGHT, HAVING A RADIUS OF 1020.00 FEET, AN ARC LENGTH OF 1138.39 FEET AND A CHORD BEARING N89°52'00"W, 1081.74 FEET TO A POINT OF BEGINNING CURVATURE; THENCE ALONG SAID CURVE, HAVING A RADIUS OF 850.00 FEET, AND AN ARC LENGTH OF 254.02 FEET, AND A CHORD BEARING N12°17'57"E, 232.09 FEET; THENCE NORTH 00°00'00", 228.84 FEET TO THE SOUTH RIGHT OF WAY CHORD BEARING N12°17'57"E, 232.09 FEET; THENCE NORTH 00°00'00", 228.84 FEET TO THE SOUTH RIGHT OF WAY LINE OF STATE HIGHWAY 30, THENCE S89°52'45"E ALONG SAID RIGHT OF WAY LINE, 250.00 FEET TO THE EAST LINE OF THE NW 1/4 OF SAID SECTION 18, THENCE NORTH 89°43'30"E ALONG SAID RIGHT OF WAY LINE, 220.01 FEET; THENCE SOUTH 00°00'00", 230.34 FEET TO THE BEGINNING OF A CURVE TO THE RIGHT, THENCE ALONG SAID CURVE TO THE RIGHT, HAVING A RADIUS OF 1000.00 FEET, AN ARC LENGTH OF 448.78 FEET AND A CHORD BEARING S17°21'59"W, 443.40 FEET TO A POINT OF REVERSE CURVATURE; THENCE ALONG SAID CURVE, HAVING A RADIUS OF 850.00 FEET, AND AN ARC LENGTH OF 343.07 FEET, AND A CHORD BEARING S00°07'45"E, 607.06 FEET TO THE SOUTH RIGHT OF WAY CHORD BEARING S17°21'59"W, 443.40 FEET TO THE BEGINNING OF A CURVE TO THE RIGHT, THENCE ALONG SAID CURVE TO THE RIGHT, HAVING A RADIUS OF 740.00 FEET, AN ARC LENGTH OF 618.15 FEET AND A CHORD BEARING S10°44'43"E, 777.11 FEET TO A POINT OF COMPOUND CURVATURE; THENCE ALONG SAID CURVE, HAVING A RADIUS OF 600.00 FEET, AND AN ARC LENGTH OF 219.04 FEET, AND A CHORD BEARING S11°11'11"W, 217.82 FEET TO THE SOUTH LINE OF THE NE 1/4 OF SAID SECTION 18, THENCE S89°57'04"W ALONG THE SOUTH LINE OF THE NE 1/4 OF SAID SECTION 18, 604.26 FEET TO THE CENTER OF SAID SECTION 18, THENCE S00°00'00"E ALONG THE EAST LINE OF THE SW 1/4 OF SAID SECTION 18, 233.00 FEET; THENCE S89°52'28"W, 683.26 FEET; THENCE NORTH 00°00'00", 253.00 FEET TO THE SOUTH LINE OF THE NW 1/4 OF SAID SECTION 18, THENCE S89°52'28"W ALONG THE SOUTH LINE OF THE NW 1/4 OF SAID SECTION 18, 2041.76 FEET TO THE POINT OF BEGINNING, CONTAINING AN AREA OF 62.26 ACRES (2,712,150 SQUARE FEET), MORE OR LESS.

I DO HEREBY CERTIFY THAT THIS PLAT IS, TO THE BEST OF MY KNOWLEDGE AND BELIEF, IN ALL RESPECTS, A TRUE DESCRIPTION OF SAID PROPERTY, AND THAT THE LOT CORNERS HAVE BEEN MONUMENTED AS DESCRIBED HEREON.

DATE: JANUARY 10, 2000
ROBERT M. TICHY
REGISTERED LAND SURVEYOR NO. LS 542
KIRKHAM MICHAEL CONSULTING ENGINEERS
1110 WEST DODGE ROAD
P.O. BOX 24129
DANNA, NEBRASKA 68124
(402) 393-5630



- ### NOTES:
- 5/8" x 24" REBAR PLACED AT ALL BLOCK CORNERS
POINTS OF CURVES, CHANGES IN DIRECTION ALONG LOT LINES AND ALL LOT CORNERS.
 - 4" DIAMETER CONCRETE MONUMENT WITH 1/2" x 2" REBAR CORE PLACED AT LOCATIONS DESIGNATED (X).

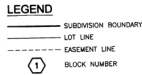

ACKNOWLEDGEMENT

STATE OF NEBRASKA) SS
COUNTY OF DODGE)
ON THIS 14th DAY OF September, 2000, A.D., BEFORE ME, A NOTARY PUBLIC IN AND FOR SAID COUNTY, PERSONALLY CAME, THE ABOVE NAMED ELDEN F. CURTIS, PRESIDENT OF ST. PATRICK'S CHURCH OF FREMONT, NEBRASKA, WHO IS PERSONALLY KNOWN TO ME TO BE THE IDENTICAL PERSON WHOSE NAME IS AFFIXED TO THE INSTRUMENT, AND HE ACKNOWLEDGES THE EXECUTION THEREOF TO BE HIS VOLUNTARY ACT AND DEED.
WITNESS MY HAND AND OFFICIAL SEAL THE LAST DATE AFORESAID.
Notary Public
My Commission Expires on the 14th DAY OF September, 2002, A.D.

ACKNOWLEDGEMENT

STATE OF NEBRASKA) SS
COUNTY OF DODGE)
ON THIS 14th DAY OF September, 2000, A.D., BEFORE ME, A NOTARY PUBLIC IN AND FOR SAID COUNTY, PERSONALLY CAME THE ABOVE NAMED OWEN W. JORTIE, SECRETARY AND TREASURER OF ST. PATRICK'S CHURCH OF FREMONT, NEBRASKA, WHO IS PERSONALLY KNOWN TO ME TO BE THE IDENTICAL PERSON WHOSE NAME IS AFFIXED TO THE INSTRUMENT, AND HE ACKNOWLEDGES THE EXECUTION THEREOF TO BE HIS VOLUNTARY ACT AND DEED.
WITNESS MY HAND AND OFFICIAL SEAL THE LAST DATE AFORESAID.
Notary Public
My Commission Expires on the 15 DAY OF Aug, 2001, A.D.

ACKNOWLEDGEMENT

STATE OF NEBRASKA) SS
COUNTY OF DODGE)
ON THIS 29th DAY OF February, 2000, A.D., BEFORE ME, A NOTARY PUBLIC IN AND FOR SAID COUNTY, PERSONALLY CAME THE ABOVE NAMED CHARLES H. DIERS, GENERAL PARTNER OF WALTER C. DIERS PARTNERSHIP, WHO IS PERSONALLY KNOWN TO ME TO BE THE IDENTICAL PERSON WHOSE NAME IS AFFIXED TO THE INSTRUMENT, AND HE ACKNOWLEDGES THE EXECUTION THEREOF TO BE HIS VOLUNTARY ACT AND DEED.
WITNESS MY HAND AND OFFICIAL SEAL THE LAST DATE AFORESAID.
Notary Public
My Commission Expires on the 17th DAY OF October, 2001, A.D.

DEDICATION

KNOW ALL MEN BY THESE PRESENTS: THAT ST. PATRICK'S CHURCH OF FREMONT, NEBRASKA, A NEBRASKA NON-PROFIT CORPORATION, ELDEN F. CURTIS, PRESIDENT AND OWEN W. JORTIE, SECRETARY AND TREASURER, TOGETHER WITH WALTER C. DIERS PARTNERSHIP, CHARLES H. DIERS, GENERAL PARTNER, OWNERS AND PROPRIETORS OF THE SAID DEDICATED TRACT, BLOCKS AND STREETS, SAID SUBDIVISION TO BE KNOWN AS DIERS ADDITION, THE LOTS AND BLOCKS TO BE NUMBERED AS SHOWN, AND WE APPROVE THE LOCATION OF THE PROPERTY AS SHOWN ON THIS PLAT TO BE BOUNDARIES OF THE PUBLIC FOR PERPETUAL PUBLIC USE. THE STREETS TO BE KNOWN AS HIGHWAY 30 ALSO GRANT EASEMENTS TO THE PUBLIC FOR PERPETUAL PUBLIC USE OF THE STREETS SHOWN ON THIS PLAT TO THE CITY OF FREMONT AND ANY PUBLIC OR PRIVATE UTILITY FOR RECIProCAL USE BY ABUTTING PROPERTY OWNERS FOR THE PURPOSE OF CONSTRUCTION AND MAINTENANCE OF UTILITY LINES, PIPES AND DRAINAGE FACILITIES. NO PERMANENT BUILDING OR RETAINING WALLS SHALL BE PLACED IN THE ABOVE DESCRIBED EASEMENT WAYS, BUT THE SAME MAY BE USED FOR GARDENS, SHRUBS, LANDSCAPING AND OTHER PURPOSES THAT DO NOT THEN OR LATER INTERFERE WITH THE AFORESAID USES OR RIGHTS HEREIN GRANTED.

IN WITNESS WHEREOF, WE DO HEREBY SET OUR HANDS THE 14th DAY OF January, 2000, A.D.

Elden F. Curtis
Elden F. Curtis, President
St. Patrick's Church of Fremont, Nebraska
Owen W. Jortie
Owen W. Jortie, Secretary and Treasurer
St. Patrick's Church of Fremont, Nebraska
Charles H. Diers
Charles H. Diers, General Partner
Walter C. Diers Partnership

APPROVAL OF CITY PLANNING COMMISSION

THIS PLAT OF DIERS ADDITION WAS APPROVED BY THE CITY PLANNING COMMISSION OF THE CITY OF FREMONT, NEBRASKA, THIS 22nd DAY OF January, 2000, A.D.
Chairman

FREMONT CITY COUNCIL ACCEPTANCE

THIS PLAT OF DIERS ADDITION WAS APPROVED BY THE CITY COUNCIL OF FREMONT, NEBRASKA, THIS 22nd DAY OF January, 2000, A.D.
Mayor City Clerk

KIRKHAM MICHAEL CONSULTING ENGINEERS
1110 WEST DODGE ROAD, DANNA, NEBRASKA 68124
(402) 393-5630 FAX (402) 253-3630